

Flui-trol pilot operated check valves 4C2M

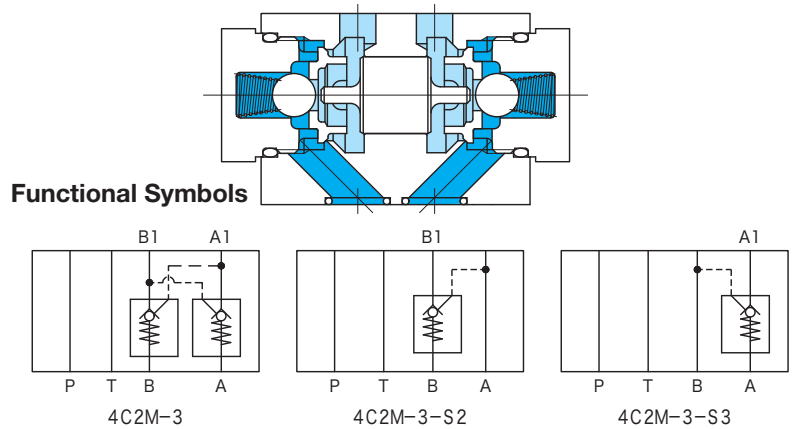

Model Code

(F3)-4C2M-3-30-JA-(S2)

1 2 3 4

- 1 Hydraulic fluid
Omit: mineral oil based fluid, water-glycol based fluid
F3: phosphate ester
- 2 Double pilot operated check valve (A, B line control)
- 3 Design no.
- 4 Special feature
S2: check function, B line only
S3: check function, A line only

Notes on Operation

- Pilot pressure P_p necessary to open valve for reverse free flow can be calculated from the following equation.
 $P_p > (P_a + P_c - P_b) / f_a + P_b$
where, P_a : A or B side pressure (reverse flow inlet)
 P_b : A1 or B1 side pressure (reverse flow outlet)
 P_c : cracking pressure
 f_a : pilot pressure ($f_a = 5$)

Specifications

Model Code	Max. Working Pressure MPa	Rated Flow L/min	Cracking Pressure MPa	Piston: Seat Area Ratio	Weight kg
4C2M	14	9	0.07	5 : 1	0.5

Characteristics Curve (at 20 mm²/s) (typical examples)

Pressure Drop Characteristics

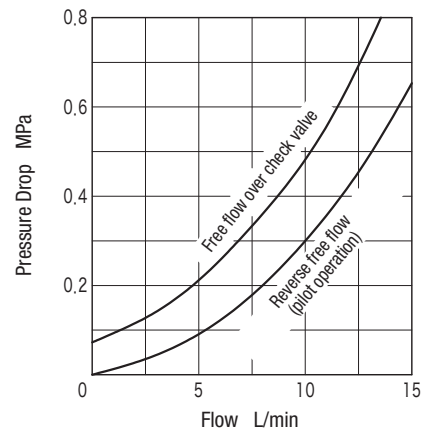

Dimensions

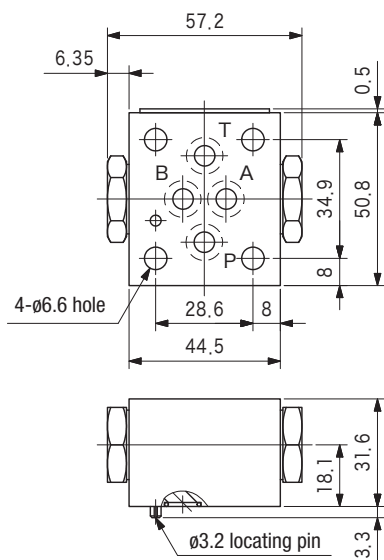

Construction

O-ring

No.	Part No.	Standard	Qty
2	007901719	AS568-017 (NBR, Hs90)	2
8	007901117	AS568-011 (NBR, Hs70)	4

